

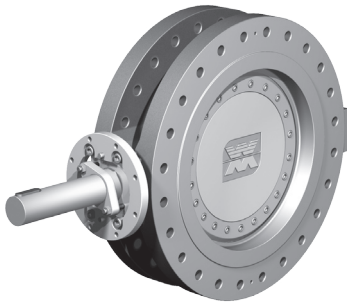

butterfly valve

type **Quadax** - double flange



butterfly valve	bare shaft
pressure range	PN 0-160 bar
size	DN 80 - 1000 mm
connection	flange

 Above stated body materials refer to the valve port connections that get in contact with the media only!

body materials	carbon steel, stainless steel, special material (duplex, inconell, bronze)
valve seat materials	inconell, others on request
seal materials	graphite / stainless steel, inconell, stainless steel, PTFE

details needed

- size
- pipe connection
- operating pressure
- flow rate
- Δp
- closing time
- media
- process temperature
- outside temperature

general specifications

pipe connection	flange	PN 10 / 16 / 25 / 40 / 63 / 100 / 160 ANSI 150 / 300 / 600 / 900
function	NC / NO / DA	depending upon actuator
pressure range	body pressure	0 to 160 bar
	Δp standard shaft	52 bar in both directions
	Δp optional shaft	100 bar in both directions
Kv value		see table
leakage rate		1 DIN 3230 A DIN EN 12266 BS 6364 Fire safe
preferred flow direction	A \leftrightarrow B	as marked
switching time	s	DN/100
process- and outside temperature	standard	- 10 °C to + 450 °C
	with special materials	- 270 °C to + 800 °C
limit switches		option
approvals		PED / Fire safe / BAM / TA Luft / ATEX in further
weight		see table
additional equipment		upon request

Kv-curve

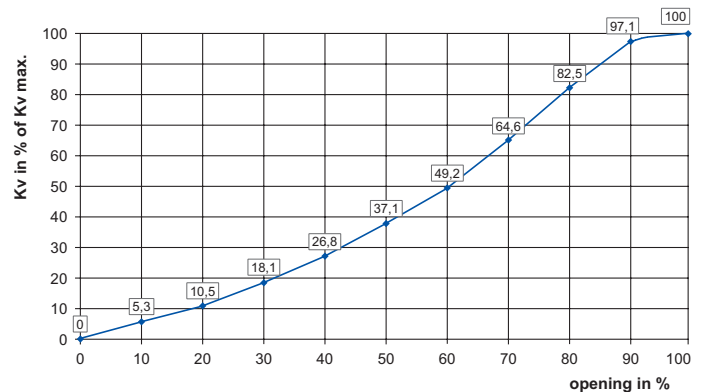

 The valves' technical design is based on media and application requirements. This can lead to deviations from the general specifications shown on the data sheet with regards to the design, sealing materials and characteristics.

 If order or application specifications are incomplete or imprecise there exists a risk of an incorrect technical design of the valve for the required application. As a consequence, the physical and / or chemical properties of the materials or seals used, may not be suitable for the intended application.

- specifications not highlighted are standard
- specifications highlighted in grey are optional

Type Quadax - double flange

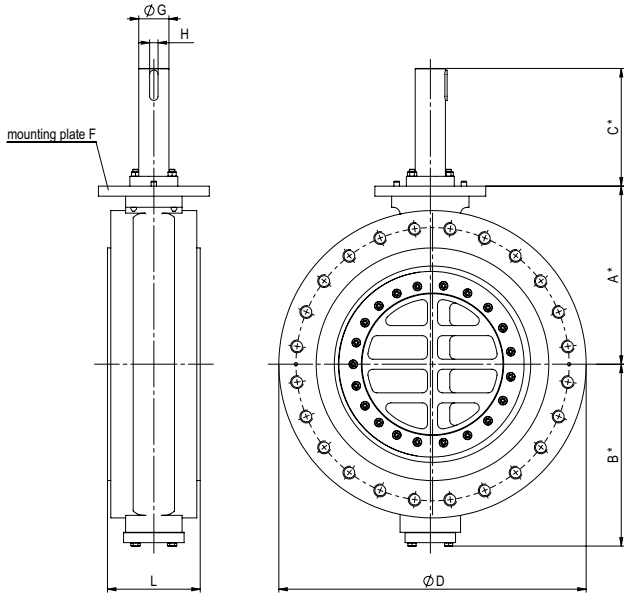

* dimensions for Trim X only

size	(mm) (inch)	80 3	100 4	125 5	150 6	200 8	250 10	300 12	350 14	400 16	450 18	500 20	600 24	700 28	750 30	800 32	900 36	1000 40
pipe cl to mounting plate	A	128	162	190	203	240	279	305	325	385	405	440	530	630	630	700	830	920
pipe cl to cover screws	B	129	158	186	204	241	281	307	333	383	403	441	541	643	643	713	836	926
bare shaft length für direct mounting	C	95	125	135	145	180	180	180	280	289	300	309	320	367	367	367	367	398
bare shaft length for adapter	C	51	68	68	68	85	85	85	173	170	170	170	170	210				
flange diameter	PN 10 PN 16 PN 25 PN 40 PN 63 PN 100 PN 160 ANSI 150 ANSI 300 ANSI 600 ANSI 900	D	D	D	D	D	D	D	D	D	D	D	D	D	D	D	D	D
		200	230	250	295	352	405	455	515	565	615	670	780	895	970	1085	1115	1230
		200	230	250	295	352	405	455	515	590	640	725	845	910	970	1085	1125	1255
		200	230	270	295	352	425	485	550	620	680	725	845	960	1020	1085	1185	1320
		200	230	270	295	375	450	515	585	660	680	770	908					
		215	250	295	345	415	470	530	600	670								
		230	265	315	355	430	505	585	655									
		230	265	315	355	430	515	585										
		190	230		280	352	405	485	550	590	640	700	815	927	984	1085	1168	1290
		210	254		320	380	445	515	585	660	710	770	908	1035	1092	1149	1270	1238
		210	275		355	420	508	560	605	685	745	815	940	1073	1130	1194	1315	1320
		240	292	350	380	470	545	610	640	705	790	860	1040	1170	1230	1315	1460	1510
mounting plate F ISO 5211	(others on request)	F	F07	F10	F12	F14	F16	F16	F25	F30	F30	F35	F35	F40	F40	F40	F48	F48
trim A	20 bar max. 290 psi max.	G	H															
		18	6	20	6	22	8	28	8	32	10	40	12	45	14	50	14	55
		20	6	22	8	28	8	32	10	40	12	45	14	50	14	55	14	60
		22	6	28	8	32	10	40	12	45	14	55	14	60	14	65	14	70
		28	6	32	10	40	12	45	14	55	14	60	14	70	14	75	14	80
		28	6	32	10	40	12	45	14	55	14	60	14	70	14	75	14	80
		32	6	32	10	40	12	45	14	55	14	60	14	70	14	75	14	80
		32	6	32	10	40	12	45	14	55	14	60	14	70	14	75	14	80
		40	6	40	10	40	12	45	14	55	14	60	14	70	14	75	14	80
		45	6	45	10	45	12	45	14	55	14	60	14	70	14	75	14	80
		55	6	55	10	55	12	45	14	55	14	60	14	70	14	75	14	80
		65	6	65	10	65	12	45	14	55	14	60	14	70	14	75	14	80
		65	6	65	10	65	12	45	14	55	14	60	14	70	14	75	14	80
		70	6	70	10	70	12	45	14	55	14	60	14	70	14	75	14	80
		75	6	75	10	75	12	45	14	55	14	60	14	70	14	75	14	80
		110	6	110	10	110	12	45	14	55	14	60	14	70	14	75	14	80
		120	6	120	10	120	12	45	14	55	14	60	14	70	14	75	14	80
		130	6	130	10	130	12	45	14	55	14	60	14	70	14	75	14	80
		150	6	150	10	150	12	45	14	55	14	60	14	70	14	75	14	80
		160	6	160	10	160	12	45	14	55	14	60	14	70	14	75	14	80
trim X (standard)	52 bar max. 754 psi max.	G	H															
		18	6	20	6	22	8	28	8	32	10	40	12	45	14	50	14	55
		20	6	22	6	28	8	32	10	40	12	45	14	50	14	55	14	60
		22	6	28	6	32	10	40	12	45	14	55	14	60	14	65	14	70
		32	6	32	10	40	12	45	14	55	14	60	14	70	14	75	14	80
		32	6	32	10	40	12	45	14	55	14	60	14	70	14	75	14	80
		40	6	40	10	40	12	45	14	55	14	60	14	70	14	75	14	80
		45	6	45	10	45	12	45	14	55	14	60	14	70	14	75	14	80
		55	6	55	10	55	12	45	14	55	14	60	14	70	14	75	14	80
		65	6	65	10	65	12	45	14	55	14	60	14	70	14	75	14	80
		65	6	65	10	65	12	45	14	55	14	60	14	70	14	75	14	80
		70	6	70	10	70	12	45	14	55	14	60	14	70	14	75	14	80
		75	6	75	10	75	12	45	14	55	14	60	14	70	14	75	14	80
		110	6	110	10	110	12	45	14	55	14	60	14	70	14	75	14	80
		120	6	120	10	120	12	45	14	55	14	60	14	70	14	75	14	80
		130	6	130	10	130	12	45	14	55	14	60	14	70	14	75	14	80
		150	6	150	10	150	12	45	14	55	14	60	14	70	14	75	14	80
		160	6	160	10	160	12	45	14	55	14	60	14	70	14	75	14	80
trim B	104 bar max. 1500 psi max.	G	H															
		22	6	28	8	32	10	40	12	45	14	55	14	60	14	65	14	70
		28	6	32	8	36	10	40	12	45	14	55	14	60	14	65	14	70
		32	6	36	10	40	12	45	14	55	14	60	14	70	14	75	14	80
		40	6	40	10	40	12	45	14	55	14	60	14	70	14	75	14	80
		45	6	45	10	45	12	45	14	55	14	60	14	70	14	75	14	80
		50	6	50	10	50	12	45	14	55	14	60	14	70	14	75	14	80
		55	6	55	10	55	12	45	14	55	14	60	14	70	14	75	14	80
		60	6	60	10	60	12	45	14	55	14	60	14	70	14	75	14	80
		65	6	65	10	65	12	45	14	55	14	60	14	70	14	75	14	80
		70	6	70	10	70	12	45	14	55	14	60	14	70	14	75	14	80
		75	6	75	10	75	12	45	14	55	14	60	14	70	14	75	14	80
		80	6	80	10	80	12	45	14	55	14	60	14	70	14	75	14	80
		85	6	85	10	85	12	45	14	55	14	60	14	70	14	75	14	80
		90	6	90	10	90	12	45	14	55	14	60	14	70	14	75	14	80
		95	6	95	10	95	12	45	14	55	14	60	14	70	14	75	14	80
		100	6	100	10	100	12	45	14	55	14	60	14	70	14	75	14	80
		105	6	105	10	105	12	45	14	55	14	60	14	70	14	75	14	80
		110	6	110	10	110	12	45	14	55	14	60	14	70	14	75	14	80
		115	6	115	10	115	12	45	14	55	14	60	14	70	14	75	14	80
		120	6	120	10	120	12	45	14	55	14	60	14	70	14	75	14	80
		125	6	125	10	125	12	45	14	55	14	60	14	70	14	75	14	80
		130	6	130	10	130	12	45	14	55	14	60	14	70	14	75	14	80
		135	6	135	10	135	12	45	14	55	14	60	14	70	14	75	14	80
		140	6	140	10	140	12	45	14	55	14	60	14	70	14	75	14	80
		145	6	145	10	145	12	45	14	55	14	60	14	70	14	75	14	80
		150	6	150	10	150	12	45	14	55	14	60	14	70	14	75	14	80
		155	6	155	10	155	12	45	14	55	14	60	14	70	14	75	14	80
		160	6	160	10	160	12	45	14	55	14	60	14	70	14	75	14	80
		165	6	165	10	165	12	45	14	55	14	60	14	70	14	75	14	80
		170	6	170	10	170	12	45	14	55	14	60	14	70	14	75	14	80
		175	6															